

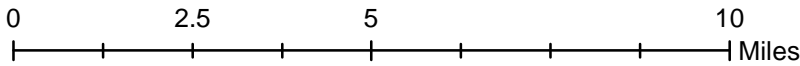

Volunteer Wildlife Monitoring Program (VWMP) Frog and Toad Survey

Route ID: 360402 Start County: Clay

Click for Google Maps to Site 1: <https://www.google.com/maps/dir/?api=1&destination=43.230999,-95.368103>

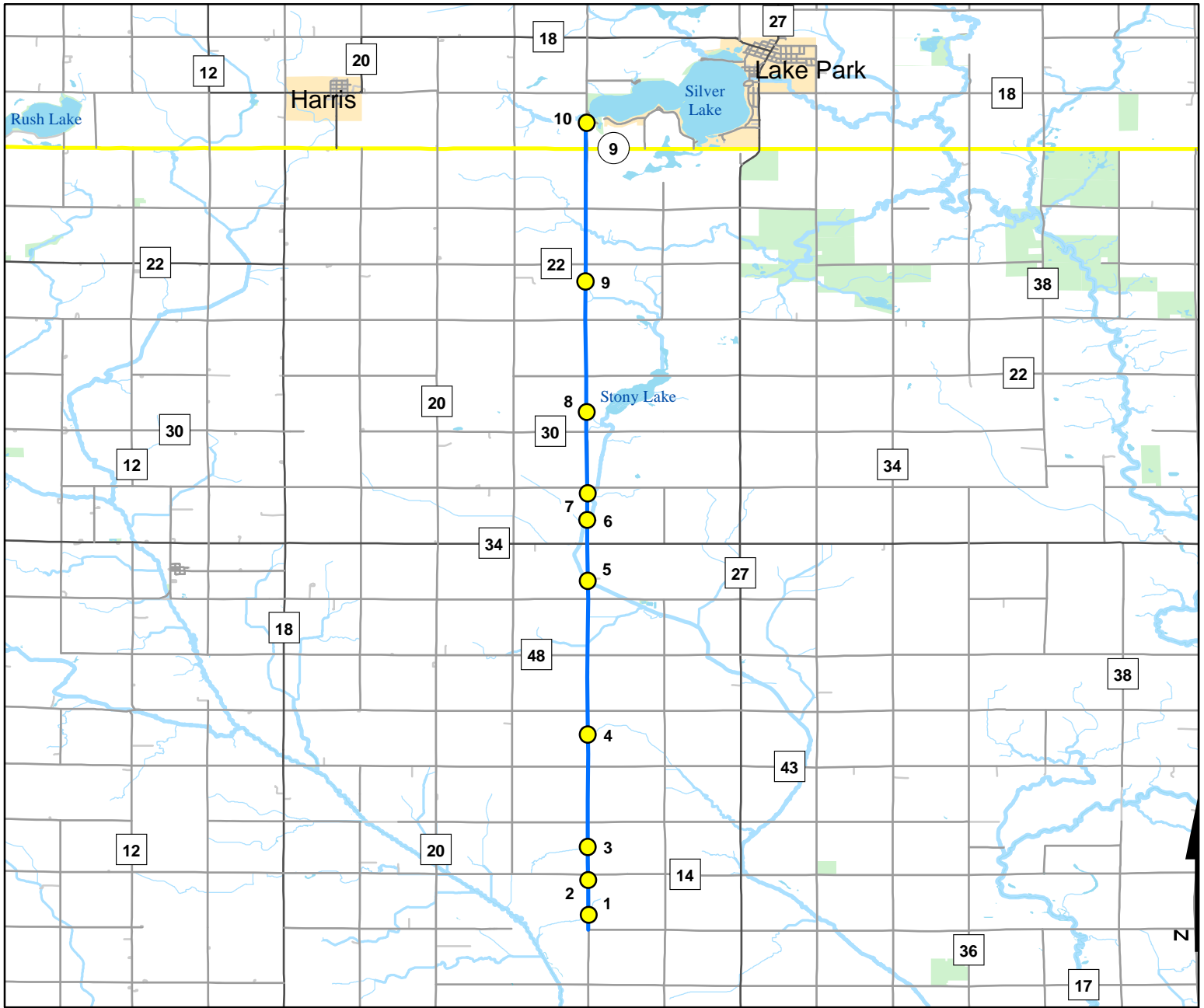

Legend

● Stop Locations

— Route Path

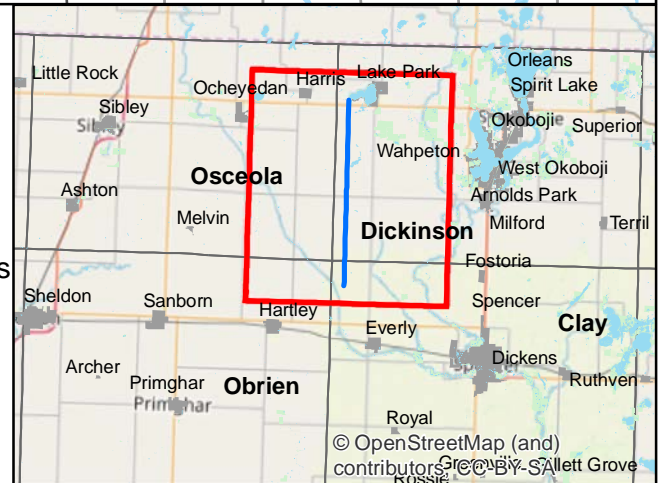



Volunteer Wildlife Monitoring Program (VWMP) Frog and Toad Survey

Route ID: 360402 Start County: Clay

Click for Google Maps to Site 1: <https://www.google.com/maps/dir/?api=1&destination=43.230999,-95.368103>

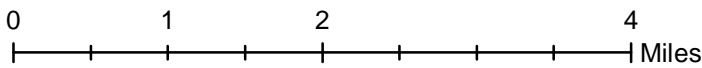
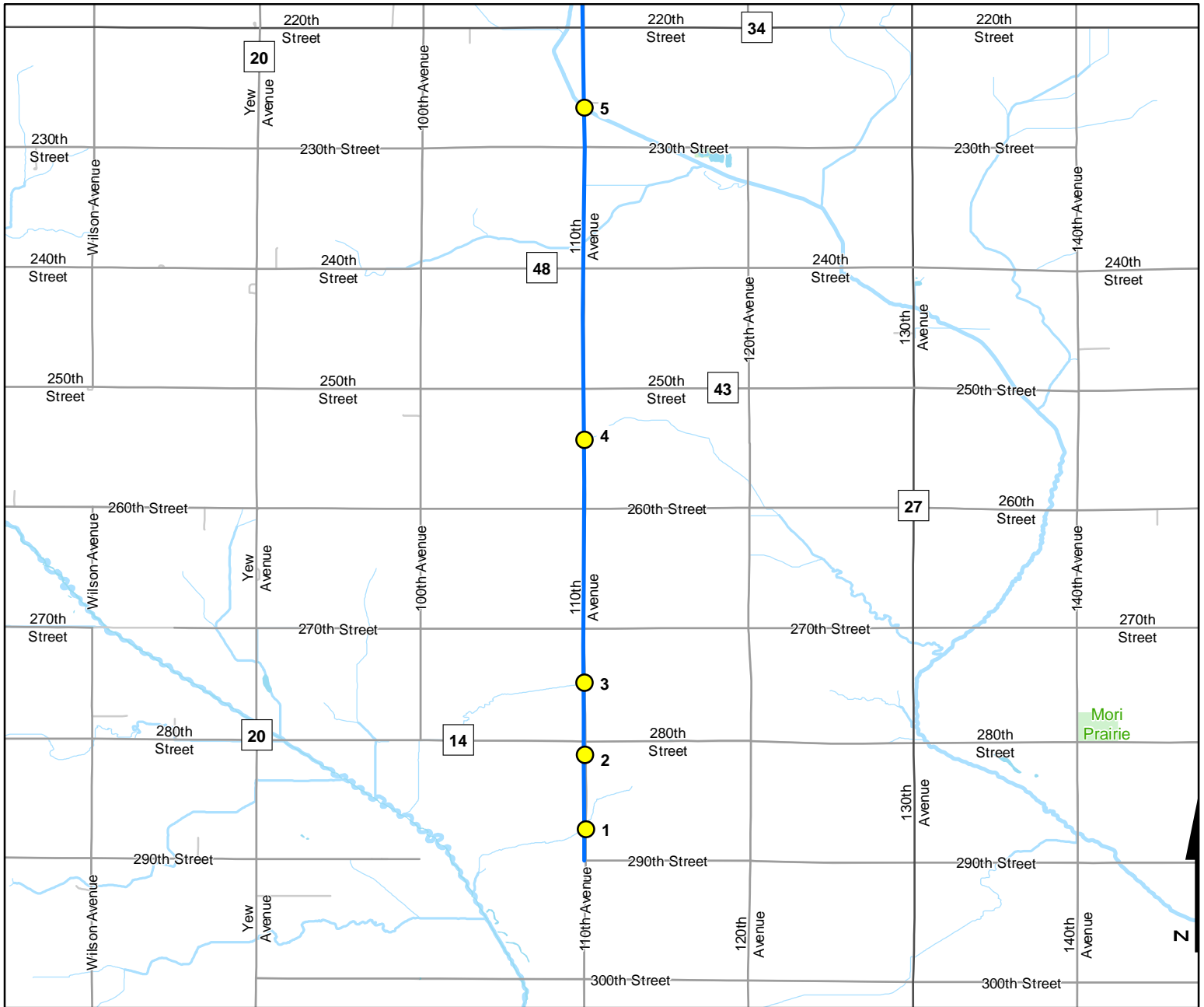

Volunteer Wildlife Monitoring Program

Legend

- Stop Locations
- Route Path





Volunteer Wildlife Monitoring Program (VWMP) Frog and Toad Survey

Route ID: 360402 Start County: Clay

Click for Google Maps to Site 1: <https://www.google.com/maps/dir/?api=1&destination=43.230999,-95.368103>

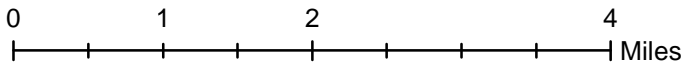
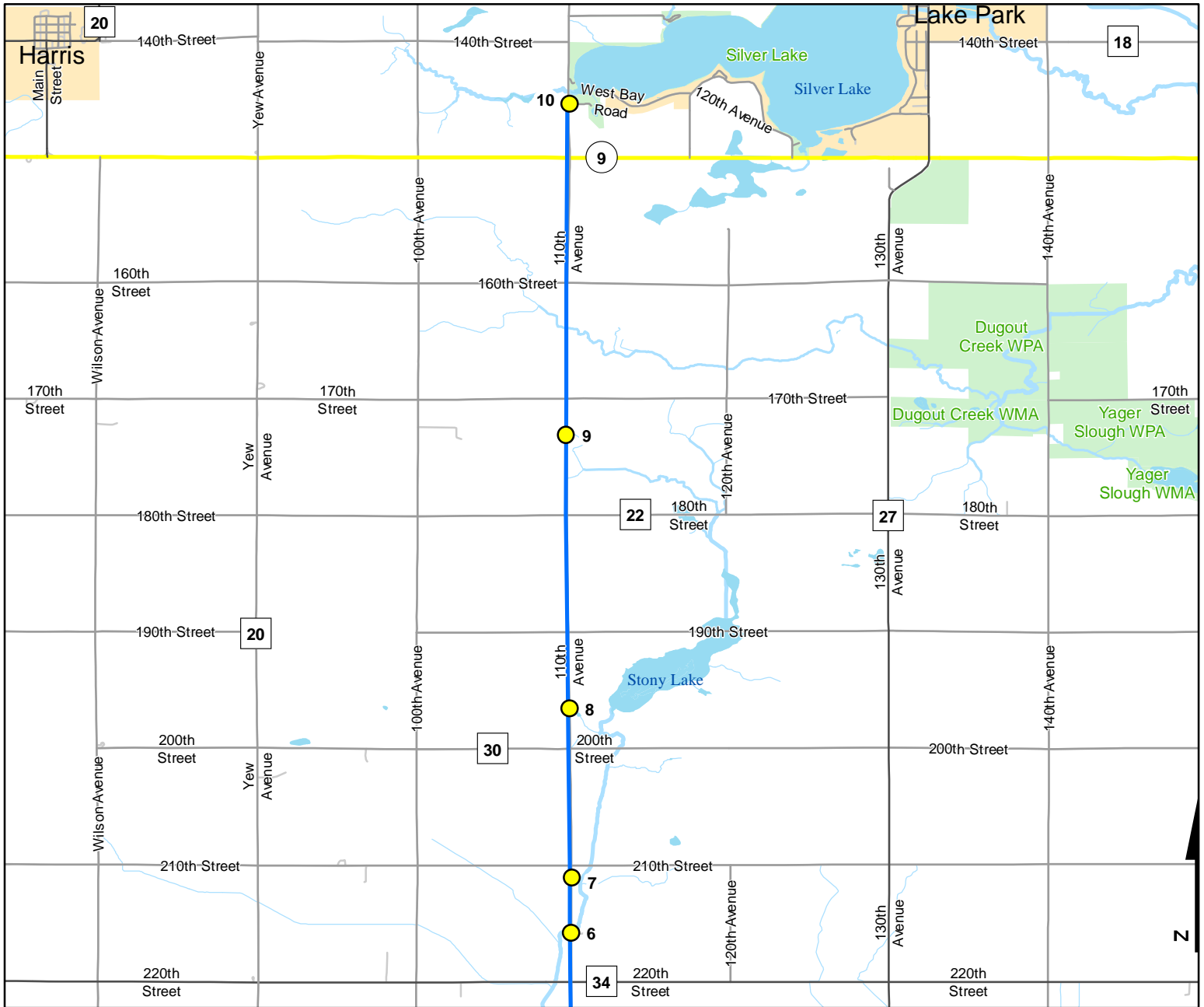

Legend

● Stop Locations

— Route Path

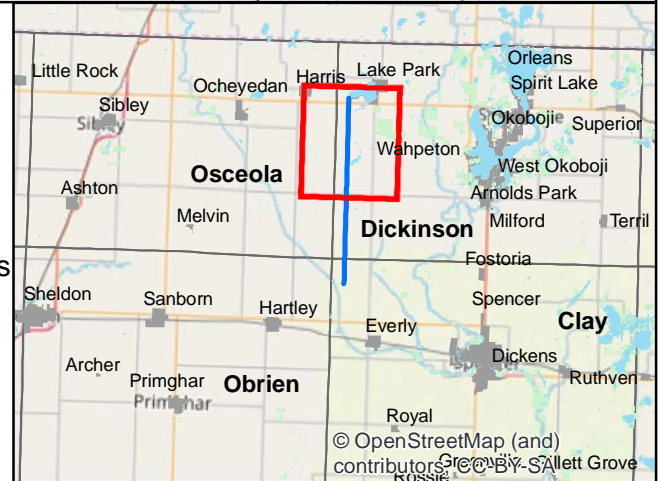



Frog and Toad Call Survey Route Description

Route ID **360402**

Established:

Site Number	Name	County	Latitude	Longitude	Directions
1	0.2	Clay	43.230999	-95.368103	Drive about .2 miles north of mapped starting point to a wide grassy waterway between crop fields on west (left) side of road.
2	0.8	Clay	43.240017	-95.3682022	Continue north on 110th about .6 miles. Deep ditch with cattails on either side of road. Can see next crossing road from stop.
3	1.4	Clay	43.2486992	-95.3683014	Continue north on 110th. About half way through next mile a small stream passes under road. Grassy on west, wooded on east. Yellow markers.
4	3.5	Dickinson	43.2779999	-95.3683014	Continue north on 110th. Stop is at wide grassed waterway through crop fields with a wetter area by road. On west is just a small grassy wet field.
5	6.2	Dickinson	43.3180008	-95.3683014	Continue north on 110th. Stop is just north of 230th.
6	7.3	Dickinson	43.3338013	-95.3684006	Continue north on 110th, cross over 220th. Stop is where small stream crosses under road. Woods on west, grassy field on east.
7	7.8	Dickinson	43.3406982	-95.3683014	Continue north on 110th just .5 miles. Open wet area on east side of road. Lots of short willows, dead trees, bee hives.
8	9.3	Dickinson	43.3618011	-95.3685989	Continue north on 110th. Shortly after crossing 200th is a small pond on east side of road in a hollow.



Frog and Toad Call Survey Route Description

9	11.7	Dickinson	43.3959007	-95.3690033	Continue north on 110th. Most of the way through the mile after 180th there is a grassy wet field. Toward the north end is a more marshy area.
10	14.5	Dickinson	43.4371986	-95.3685989	Continue north on 110th, cross over Hwy 9. 1/2 mile north of 9 pull into driveway with Silver Lake Fen Preserve sign (1st driveway!)